



# 4040 Creditview Drive Mississauga, Ontario

## Unit 5

<b>Square Feet</b>	1,000 SF
<b>Rental Rate</b>	Please contact
<b>Availability</b>	Immediate
<b>Term</b>	Five Years
<b>Built</b>	1983 & 1990

## Features

- Erindale GO Station behind the plaza,
- CIBC Bank
- Tim Horton's,
- medical & dental doctors
- both residential and commercial clientele in its trading area.
- Retail GLA: 85,000 square feet
- Parking: 500 spots.
- Year Built: 1983 & 1990



4040 Creditview Drive  
Mississauga, Ontario

UNIT 5 - 1000sf

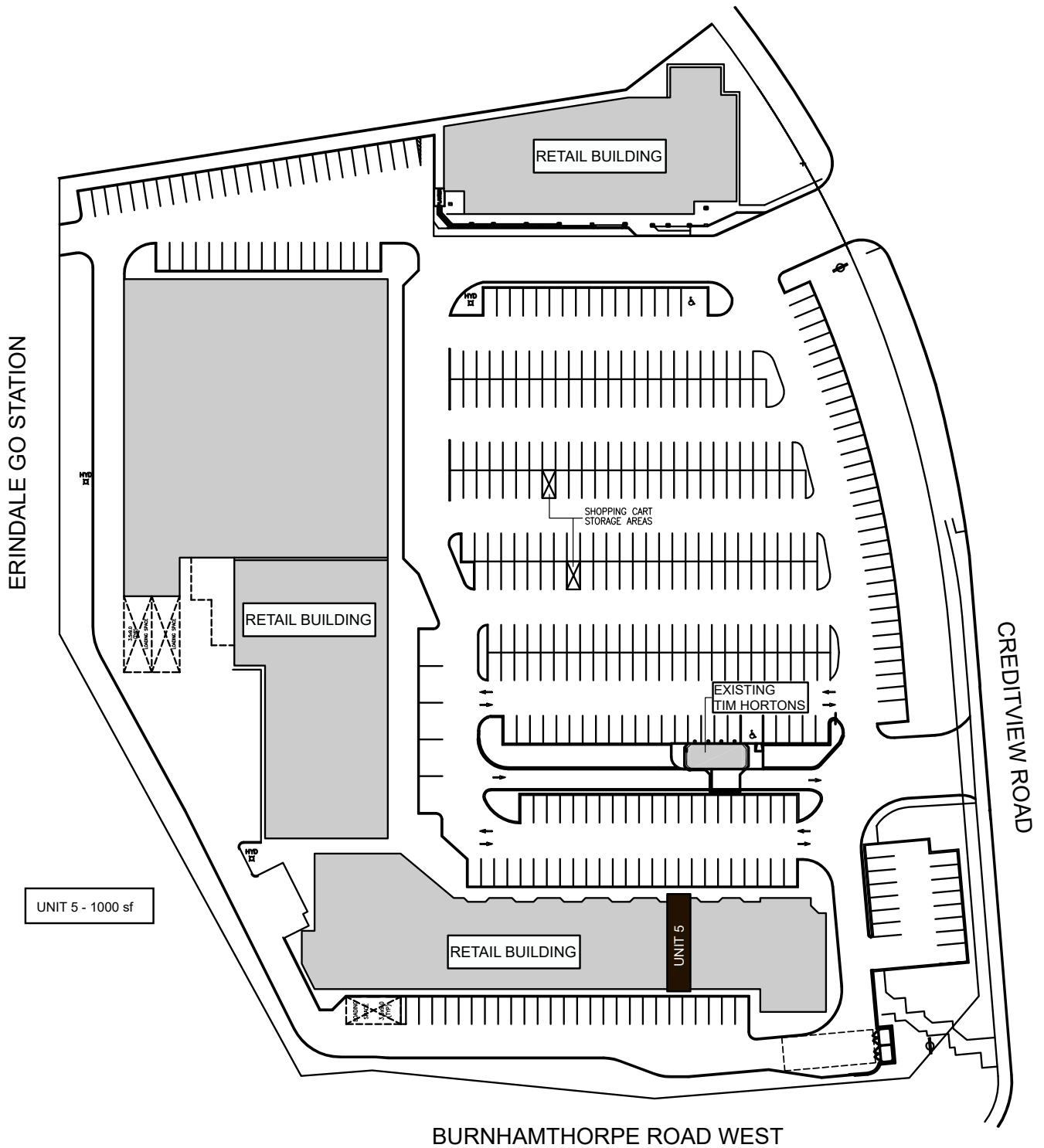

YAD INVESTMENTS LIMITED



197 Spadina Avenue, Suite 500  
Toronto Ontario M5T 2C8

tel: 416-977-7781  
fax: 416-977-3451

4040 Creditview Drive  
Mississauga, Ontario

UNIT 5 - 1000sf

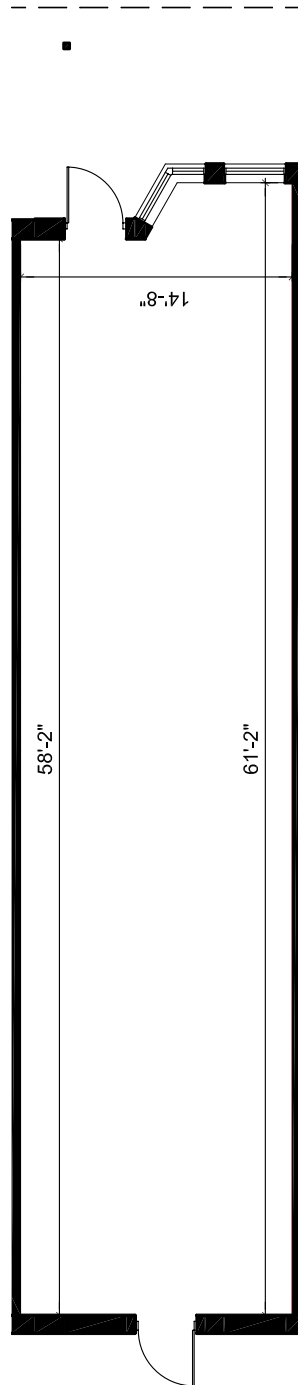

YAD INVESTMENTS LIMITED



197 Spadina Avenue, Suite 500  
Toronto Ontario M5T 2C8

tel: 416-977-7781  
fax: 416-977-3451